

- - - - - EXISTING OHL TO REMAIN
- - - - - EXISTING OHL TO REMOVE
- - - - - PROPOSED NEW UGC
- - - - - PROPOSED SUBSTATION
- - - - - EXISTING LAND OWNERSHIP BOUNDARY
- - - - - PROPOSED DEVELOPMENT BOUNDARY
- - - - - PROPOSED ACCESS ROAD
- - - - - APPROXIMATE RURAL SUPPLY UGC ROUTE

1. DRAWINGS ARE FOR PLANNING ONLY AND SHOULD NOT BE USED FOR DETAILED DESIGN. EQUIPMENT DIMENSIONS MAY CHANGE ONCE THE EXACT SPECIFICATIONS ARE DETERMINED.
2. THE SUBSTATION IS BASED ON THE LATEST EIRGRID STANDARD (KDN-LAY-ELV-STND-F-001-R02 AS OF 13/02/2020).
3. SUBSTATION COMPOUND COORDINATES ARE 53°29'33.16"N, 6°38'33.31"W.
4. THIS DRAWING IS NOT TO BE SCALED, ALL DIMENSIONS ARE IN METERS.

NO.	DATE	DESCRIPTION
P4	20/06/2023	FOR PLANNING
P3	09/11/2022	CLIENT COMMENTS
P2	10/10/2022	CLIENT COMMENTS
P1	19/09/2022	CLIENT COMMENTS
P0	27/05/2022	FIRST ISSUE FOR PLANNING
I/R	DATE	DESCRIPTION

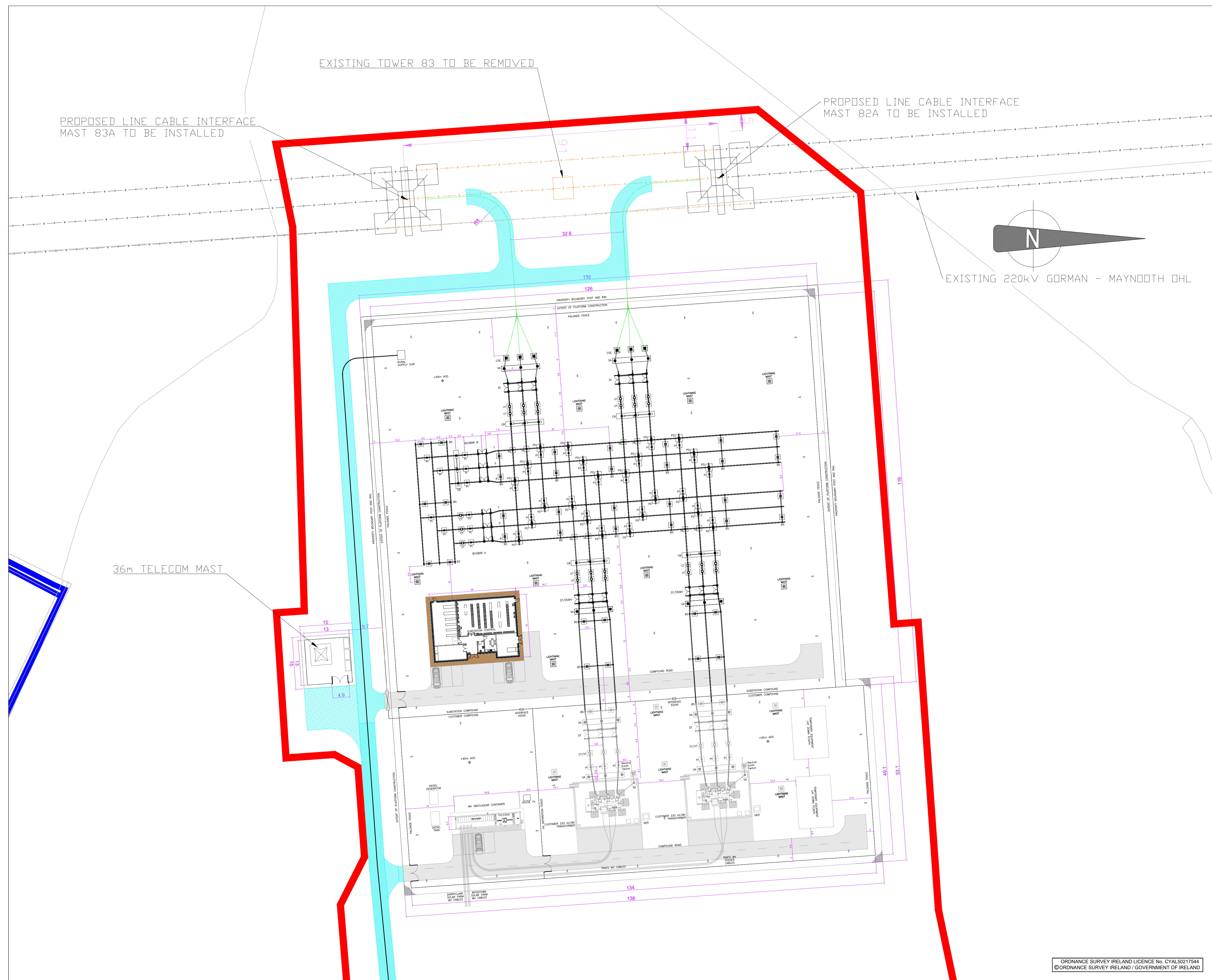

EXISTING 220kV GORMAN - MAYNOOTH OHL

36m TELECOM MAST

EXISTING TOWER 83 TO BE REMOVED

PROPOSED LINE CABLE INTERFACE MAST 83A TO BE INSTALLED

PROPOSED LINE CABLE INTERFACE MAST 82A TO BE INSTALLED

This drawing has been prepared for the use of AECOM's client. It may not be used, modified, reproduced or relied upon by third parties, except as agreed by AECOM or as required by law. AECOM accepts no responsibility, and denies any liability whatsoever, to any party that uses or relies on this drawing without AECOM's express written consent. Do not scale this document. All measurements must be obtained from the stated dimensions.