

TOP VIEW
Scale 1:2

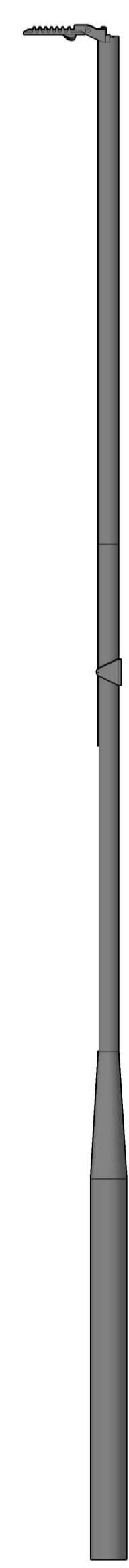

FRONT ELEVATION
Scale 1:20

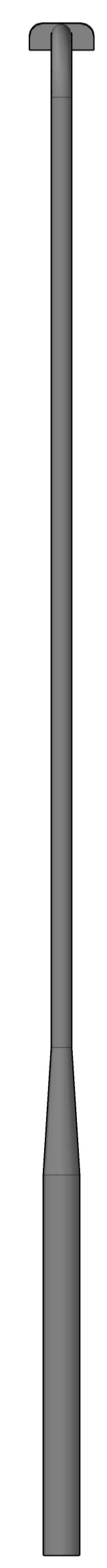

SIDE ELEVATION
Scale 1:20

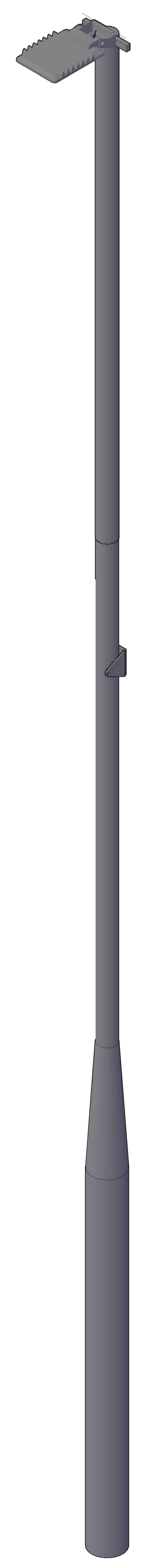

ISOMETRIC VIEW
Scale 1:10

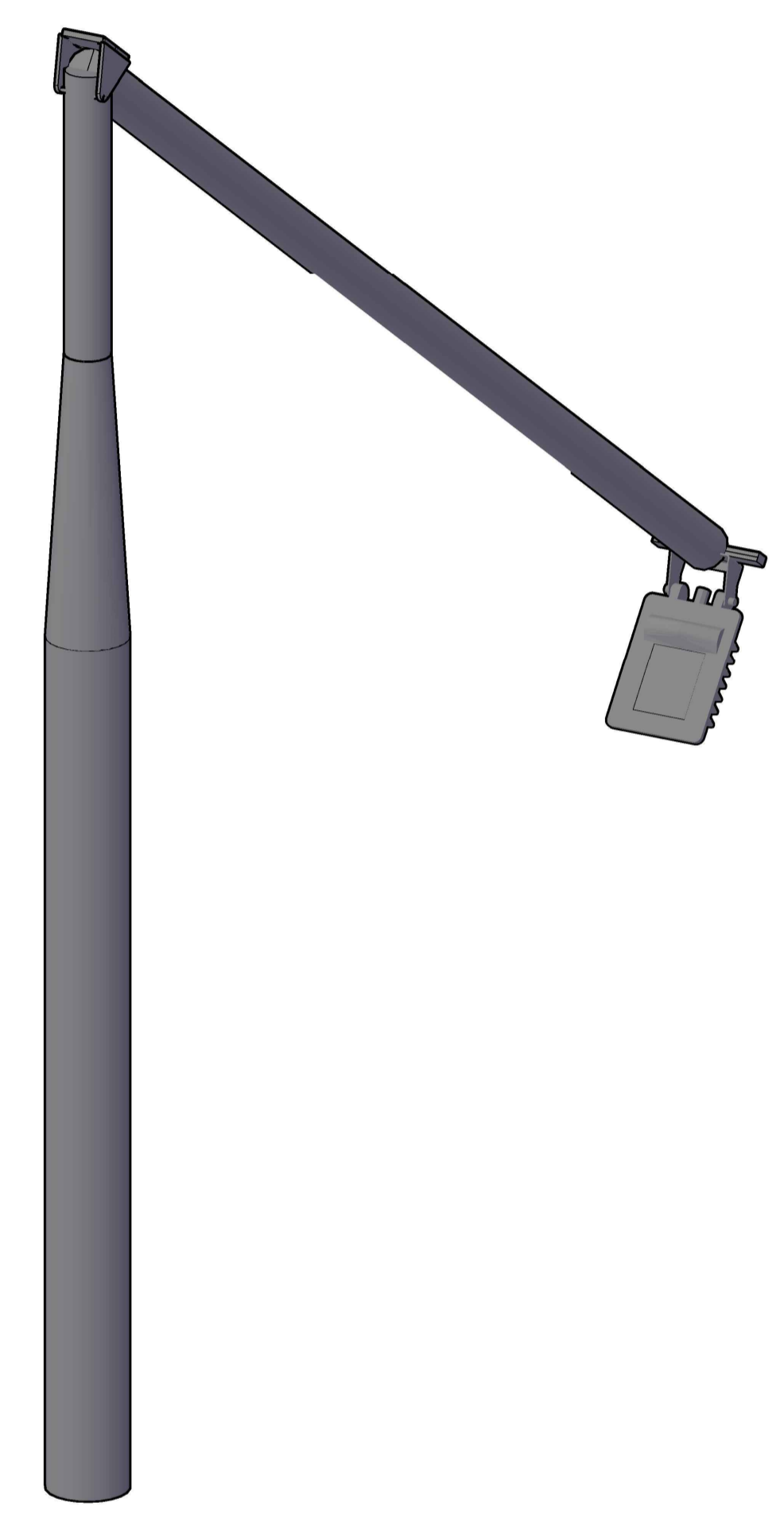

VIEW OF HINGED MECHANISM IN OPERATION
Scale 1:10

NOTES

- DRAWINGS ARE FOR PLANNING ONLY AND SHOULD NOT BE USED FOR A DETAILED DESIGN;
- THIS LIGHTING POLE IS INDICATIVE ONLY. MANUFACTURERS DETAILS SHOULD BE CONFIRMED UPON THE COMMENCEMENT OF A DETAILED DESIGN;
- DRAWING REPRESENTS A SIMILAR LAMP RETRIEVED FROM DIALUX SOFTWARE. LAMP DETAILS & DIMENSIONS TO BE CONFIRMED DURING THE DETAILED DESIGN STAGE.

ISSUE/REVISION

I/R	DATE	DESCRIPTION
P1	20/06/2023	FOR PLANNING
P0	27/05/2022	FIRST ISSUE

STATUS

FOR PLANNING

PROJECT NUMBER 60657534 SCALE VARIES @ A1

SHEET TITLE

CULMULLIN 220KV SUBSTATION
TYPICAL LIGHTING POLE DETAILS

SHEET NUMBER 60657534-ACM-DWG-513 REV P1

This drawing has been prepared for the use of AECOM's client. It may not be used, modified, reproduced or relied upon by third parties, except as agreed by AECOM or as required by law. AECOM accepts no responsibility, and denies any liability, whatsoever, to any party that uses or relies on this drawing without AECOM's express written consent. Do not scale this document. All measurements must be obtained from the stated dimensions.